

# uniq-wall

redefining spaces



## [soli]tude Acoustic operable moving walls

[soli]tude is the ultimate in terms of acoustic integrity, achieving the very highest possible sound ratings.

Both our Twin Point and Single Point systems glide along a recessed or surface-mounted ceiling track, leaving the floor free of any track or obstruction.

Complex track layouts can be specified for unlimited room configuration options, and an almost unlimited plethora of finishes provides endless design opportunities. Available in manual and semi-auto electrically operated versions.



# [soli]tude

## Acoustic operable moving walls

- 1. Expanding Jamb
- 2. E-Basic Panel
- 3. Standard Panel
- 4. Fixed Jamb
- 5. Single Point
- 6. Twin Point
- 7. Floor Seal
- 8. SP with Pelmet
- 9. TP with Pelmet

### TECHNICAL DETAILS

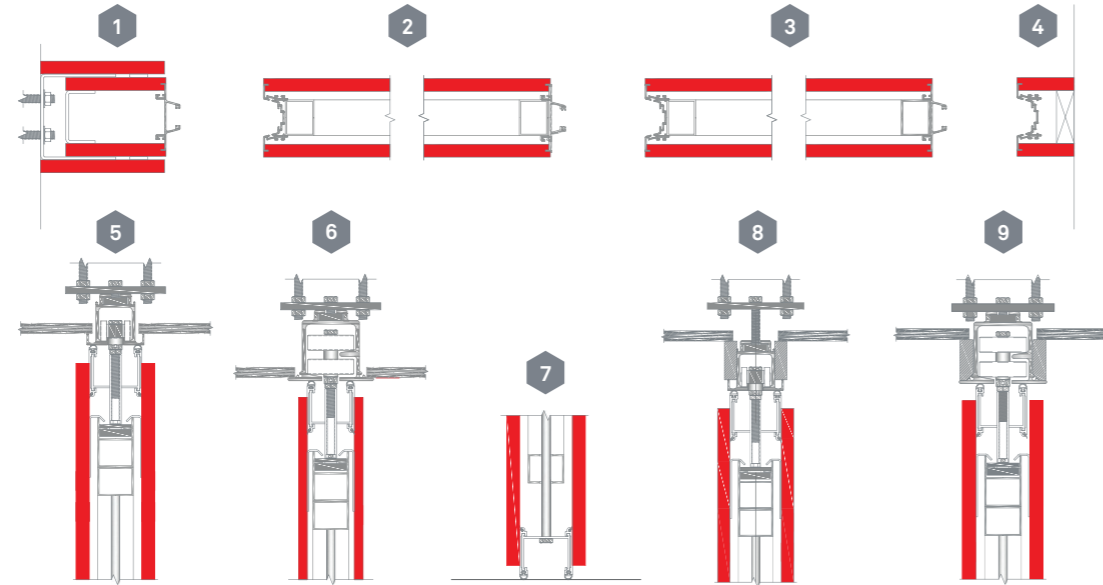

### STANDARD STACKING CONFIGURATIONS

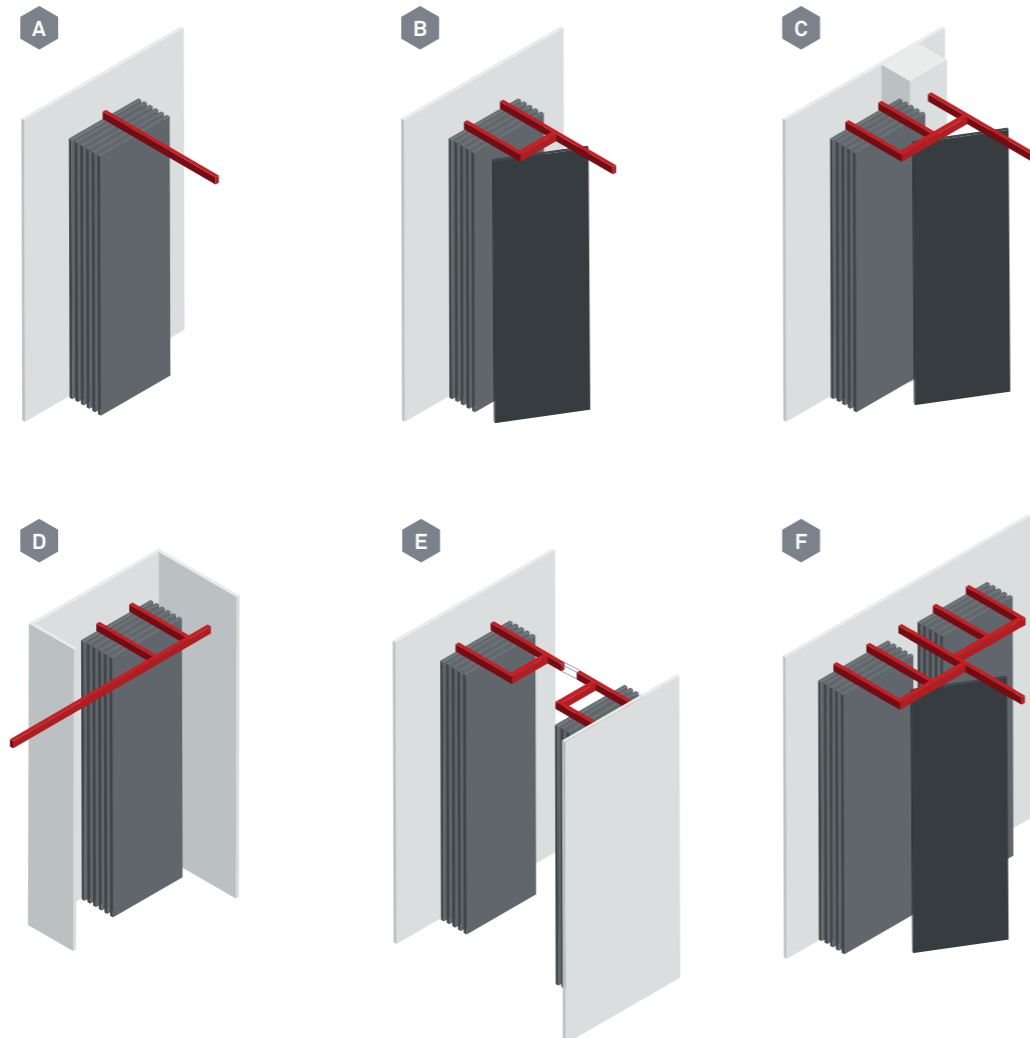

- Config A  
Single-point
- Config B  
Twin-point,  
H-park
- Config C  
Twin-point,  
Offset Stack
- Config D  
Twin-point,  
Linear Stack
- Config E  
Twin-point,  
H-park Split
- Config F  
Twin-point,  
Split Offset Track

**Please note:**  
Panel thickness will vary depending on system type.  
Other stacking options are available on request.  
Please contact uniq-wall for further details.

\*Anything over 3750mm must be TP.

Contact Creatif for special requirements.

Numbers in brackets ( ) represent system availability

Other finish types available:

- » Magnetic
- » Drywipe
- » Pinnable
- » Printed board
- » Veneer
- » OSB
- » Glass

Numbers in Brackets ( ) represent system availability

For constraints and variations contact uniq-wall: info@uniqwall.ca

Ironmongery and Vision panels subject to constraints, contact us for information

### TECHNICAL INFORMATION

	[soli]tude			
	116	122	134	Pass Door
Acoustic rating STC	>50	50> 57	57	50-57
Panel thickness	116mm	122mm	varies	varies
Weight KG/M2	47KG	64KG	varies	varies
Max. height	5000mm*	5000mm*	5000mm*	4000mm*
Max. panel width	1220mm	1220mm	1220mm	1220mm
Panel construction	Aluminium (inc. steel over 3m)	Aluminium (inc. steel over 3m)	Aluminium (inc. steel over 3m)	Aluminium and steel
Operable seal	Manual or Electric	Manual or Electric	Manual or Electric	Manual or Electric
Panel construction	MFC – 18mm	MFC – 25mm	MDF – 15mm + fabric	varies
Track system	Aluminium TP + SP	Aluminium TP + SP	Aluminium TP + SP	Aluminium TP + SP
Tolerance height MM	-/+ 5mm	-/+ 5mm	-/+ 5mm	-/+ 5mm
Tolerance width MM	-/+ 10mm	-/+ 10mm	-/+ 10mm	-/+ 10mm

### SWATCHES

#### Popular Finishes

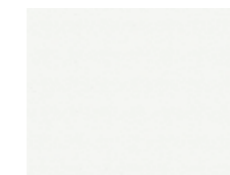

White

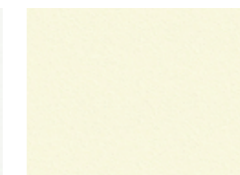

Alabaster



Light Grey

#### Fabric Finishes



Various Colours



Maple

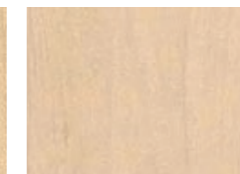

Birch



Beech



Printed Fabric



Cherry



Natural Lancaster Oak

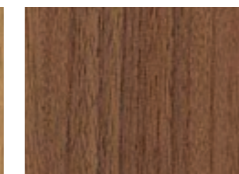

Walnut

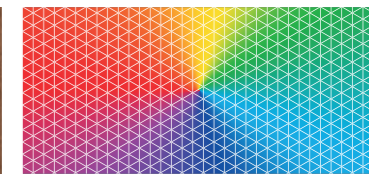

Other colours available on request

### AVAILABLE PANELS ELEVATIONS

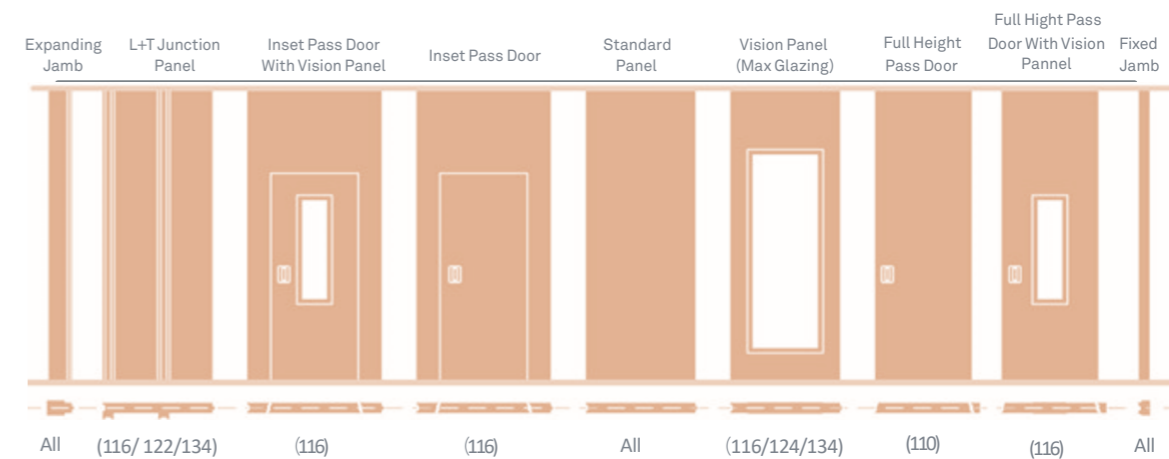

All (116/ 122/134) (116) (116) All (116/124/134) (110) (116) All



### FEATURES & BENEFITS

- » Offers space flexibility – configurable space.
- » High acoustic integrity – minimal noise transfer between spaces.
- » Huge variety of finishes – enhanced aesthetics and variety of practical uses.
- » Manual or electrically operated seals (top, bottom and expandable)– ease and speed of use.
- » Multiple panel options and sizes – tailored to suit the specific space.
- » No floor track – unbroken floor surface.



HEAD OFFICE Cooks Construction 5-240007 Frontier Crescent, Rocky View, T1X0R4

Russell Cook: (cell) 587-370-8796 (email) russ@cooksconstruction.net

John Mackenzie: (cell) 1-(416)-474-9955 (email) johnm@cooksconstruction.net

WWW.COOKSCONSTRUCTION.NET

**uniq-wall**  
redefining spaces

Head Office  
1472 Thornton Road N, B14  
Oshawa, ON Canada  
LOB 1A0

T 416-335-9119  
F 1-888-347-9909  
E info@uniqwall.ca

[www.uniqwall.ca](http://www.uniqwall.ca)